



**THALHIMER**

OFFICE/WAREHOUSE FOR LEASE  
**Crescent Business Center VI**  
Lakeridge Parkway | Hanover County, Virginia

COMING SOON



**20,000 - 54,801 SF Warehouse/Distribution/Manufacturing Space**

For more information, contact:

**SCOTT DOUGLAS, SIOR**

Senior Vice President

804 697 3422

[scott.douglas@thalhimer.com](mailto:scott.douglas@thalhimer.com)

**GRAHAM STONEBURNER**

Senior Vice President

804 344 7159

[graham.stoneburner@thalhimer.com](mailto:graham.stoneburner@thalhimer.com)

Thalhimer Center  
11100 W. Broad Street  
Glen Allen, VA 23060  
[www.thalhimer.com](http://www.thalhimer.com)

Independently Owned and Operated / A Member of the Cushman & Wakefield Alliance

Cushman & Wakefield \ Thalhimer © 2015. No warranty or representation, express or implied, is made to the accuracy or completeness of the information contained herein, and same is submitted subject to errors, omissions, change of price, rental or other conditions, withdrawal without notice, and to any special listing conditions imposed by the property owner(s). As applicable, we make no representation as to the condition of the property (or properties) in question.



**THALHIMER**

## OFFICE/WAREHOUSE FOR LEASE

# Crescent Business Center VI

Lakeridge Parkway | Hanover County, Virginia

### Property Features

- 20,000 - 54,801 SF AVAILABLE
- Atlee/Elmont exit off I-95
- Class A distribution/flex facility
- 138' deep truck court
- 9' store front glass

### Building Features

Total Available	20,000 - 54,801 SF
Bays	Approximately 50' x 180'
Loading	Dock and drive-in
Sprinkler	ESFR (high capacity)
Ceiling Height	24' clear

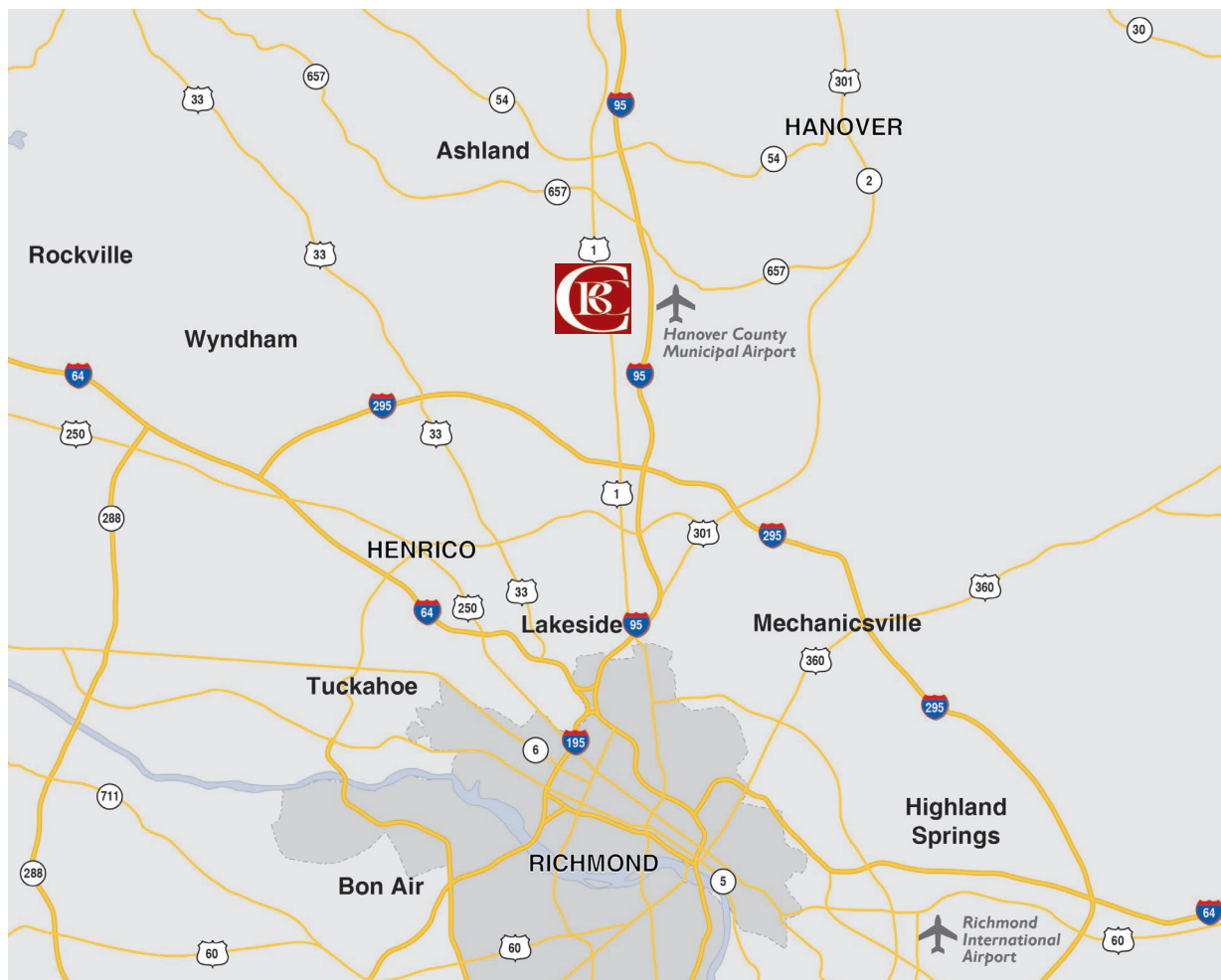

For more information, contact:

#### SCOTT DOUGLAS, SIOR

Senior Vice President  
804 697 3422  
[scott.douglas@thalhimer.com](mailto:scott.douglas@thalhimer.com)

#### GRAHAM STONEBURNER

Senior Vice President  
804 344 7159  
[graham.stoneburner@thalhimer.com](mailto:graham.stoneburner@thalhimer.com)

Thalhimer Center  
11100 W. Broad Street  
Glen Allen, VA 23060  
[www.thalhimer.com](http://www.thalhimer.com)

Independently Owned and Operated / A Member of the Cushman & Wakefield Alliance

Cushman & Wakefield | Thalhimer © 2015. No warranty or representation, express or implied, is made to the accuracy or completeness of the information contained herein, and same is submitted subject to errors, omissions, change of price, rental or other conditions, withdrawal without notice, and to any special listing conditions imposed by the property owner(s). As applicable, we make no representation as to the condition of the property (or properties) in question.



**THALHIMER**

**OFFICE/WAREHOUSE FOR LEASE**  
**Crescent Business Center VI**  
Lakeridge Parkway | Hanover County, Virginia

**To be Constructed | 54,800+ SF Office/Warehouse Structure**

Clear Height:	24'	Rear Wall Panels:	Knock out panels for future dock levelers (1) 5'-4" x 15' transom window per panel at rear wall, warehouse clerestory windows
Building Dimensions:	Depth Approximately 180' Length Approximately 296'	Side Elevation:	(3) 5' x 4'-6" knock out panels for future punched windows Concrete and EIFS detailing (consistent with Crescent Business Center)
Floor Slab:	6" of compacted stone 8 mil poly vapor barrier 6x6xW2.1xW2.1 welded wire fabric 4,000 PSI, 5" thick concrete with saw cut joints	Roof:	White Carlyle TPO (reduces utility costs) Polyisocyanurate Rigid Insulation board, R = 20
Structural Bays:	Typical column widths at increments of 40' front to back by 50' side by side	Roof Access:	One caged roof access ladder
Front Elevation:	Storefront entry alcoves (consistent with adjacent Crescent Building V)	Interior Riser Room:	For fire suppression system riser, domestic water rise, alarm panel, house panel, and telephone boards
Rear Loading Dock:	Pre-engineered 9' x 10' overhead doors, 24 gauge steel within a 12' x 14' knock-out panel for drive-in doors  One ramped drive-in 12' x 14' overhead doors at each end	Sprinkler:	Wet ESFR rated sprinkler system
Personnel Doors:	Galvanized steel stairs. Platforms covered by pre-finished metal awnings	Electric:	480/277, 3-phase, 4-wire high voltage to Building
Lighting:	LED warehouse lighting	Exterior:	8" concrete, architectural panels, poured on slab

For more information, contact:

**SCOTT DOUGLAS, SIOR**  
Senior Vice President  
804 697 3422  
[scott.douglas@thalhimer.com](mailto:scott.douglas@thalhimer.com)

**GRAHAM STONEBURNER**  
Senior Vice President  
804 344 7159  
[graham.stoneburner@thalhimer.com](mailto:graham.stoneburner@thalhimer.com)

Thalhimer Center  
11100 W. Broad Street  
Glen Allen, VA 23060  
[www.thalhimer.com](http://www.thalhimer.com)

Independently Owned and Operated / A Member of the Cushman & Wakefield Alliance

Cushman & Wakefield | Thalhimer © 2015. No warranty or representation, express or implied, is made to the accuracy or completeness of the information contained herein, and same is submitted subject to errors, omissions, change of price, rental or other conditions, withdrawal without notice, and to any special listing conditions imposed by the property owner(s). As applicable, we make no representation as to the condition of the property (or properties) in question.



**THALHIMER**

# OFFICE/WAREHOUSE FOR LEASE

## Crescent Business Center VI

Lakeridge Parkway | Hanover County, Virginia

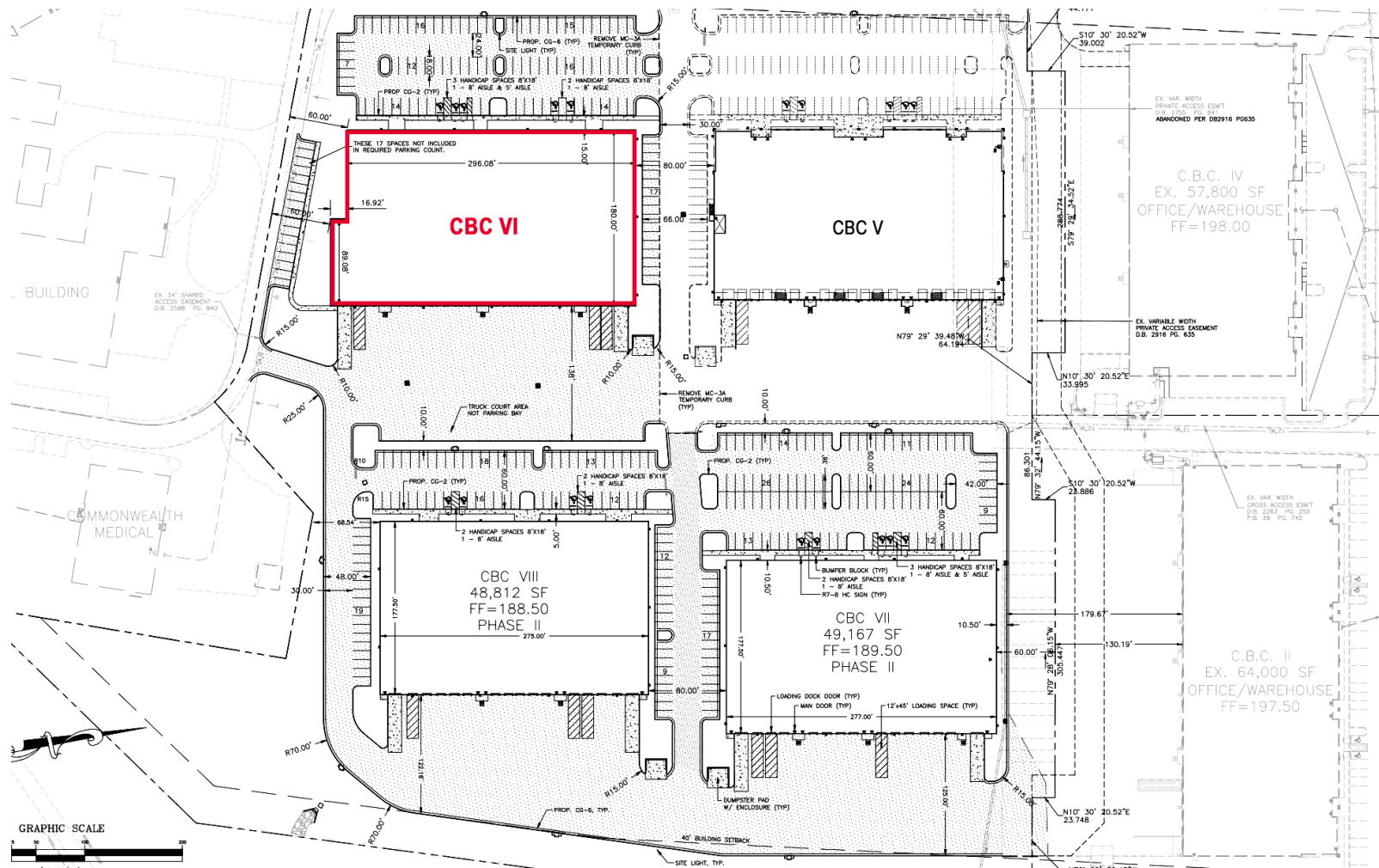

For more information, contact:

**SCOTT DOUGLAS, SIOR**  
Senior Vice President  
804 697 3422  
scott.douglas@thalhimer.com

**GRAHAM STONEBURNER**  
Senior Vice President  
804 344 7159  
graham.stoneburner@thalhimer.com

Thalhimer Center  
11100 W. Broad Street  
Glen Allen, VA 23060  
www.thalhimer.com

Independently Owned and Operated / A Member of the Cushman & Wakefield Alliance

Cushman & Wakefield | Thalhimer © 2015. No warranty or representation, express or implied, is made to the accuracy or completeness of the information contained herein, and same is submitted subject to errors, omissions, change of price, rental or other conditions, withdrawal without notice, and to any special listing conditions imposed by the property owner(s). As applicable, we make no representation as to the condition of the property (or properties) in question.





**THALHIMER**

# OFFICE/WAREHOUSE FOR LEASE

## Crescent Business Center VI

Lakeridge Parkway | Hanover County, Virginia

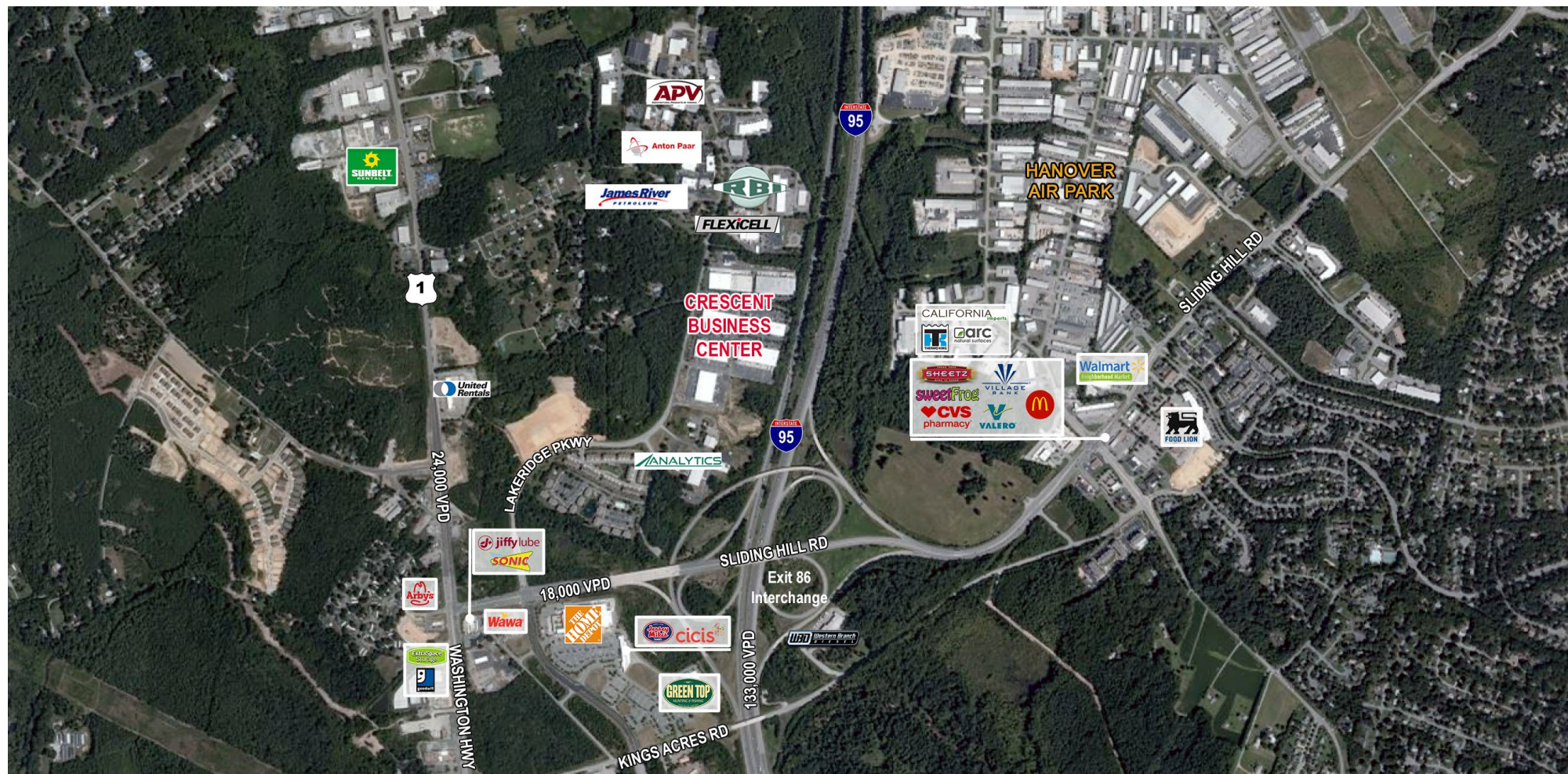

For more information, contact:

**SCOTT DOUGLAS, SIOR**

Senior Vice President

804 697 3422

[scott.douglas@thalhimer.com](mailto:scott.douglas@thalhimer.com)

**GRAHAM STONEBURNER**

Senior Vice President

804 344 7159

[graham.stoneburner@thalhimer.com](mailto:graham.stoneburner@thalhimer.com)

Thalhimer Center  
11100 W. Broad Street  
Glen Allen, VA 23060  
[www.thalhimer.com](http://www.thalhimer.com)

Independently Owned and Operated / A Member of the Cushman & Wakefield Alliance

Cushman & Wakefield | Thalhimer © 2015. No warranty or representation, express or implied, is made to the accuracy or completeness of the information contained herein, and same is submitted subject to errors, omissions, change of price, rental or other conditions, withdrawal without notice, and to any special listing conditions imposed by the property owner(s). As applicable, we make no representation as to the condition of the property (or properties) in question.